



*Road Running Technical Council*  
*USA Track & Field*  
**Measurement Certificate**



Name of the course \_\_\_\_\_ Distance \_\_\_\_\_

Location (state) \_\_\_\_\_ (city) \_\_\_\_\_

Type of course: road race      calibration      track      Configuration: \_\_\_\_\_

Type of surface: paved \_\_\_\_\_ %    dirt \_\_\_\_\_ %    gravel \_\_\_\_\_ %    grass \_\_\_\_\_ %    track \_\_\_\_\_ %

Elevation      above sea level)    Start \_\_\_\_\_    Finish \_\_\_\_\_    Highest \_\_\_\_\_    Lowest \_\_\_\_\_

Straight line distance between start & finish \_\_\_\_\_    Drop \_\_\_\_\_ m/km    Separation \_\_\_\_\_ %

Measured by (name, address, phone & e-mail) \_\_\_\_\_

Race contact (name, address & phone) \_\_\_\_\_

Measuring Methods:    bicycle      steel tape      electronic distance meter

Number of measurements of entire course: \_\_\_\_\_ Date(s) when course measured: \_\_\_\_\_

Race date: \_\_\_\_\_ Course paperwork submission date: \_\_\_\_\_

Replaces: \_\_\_\_\_ (if applicable)      Certification code: \_\_\_\_\_

Notice to Race Director  
 Use this Certification Code in *all* public  
 announcements relating to your race.

***Be It Officially Noted That***

Based on examination of data provided by the above named measurer, the course described above and in the map attached is hereby certified as reasonably accurate in measurement according to the standards adopted by the Road Running Technical Council. If *any* changes are made to the course, this certification becomes void, and the course must then be recertified.

**Validation of Course** — In the event a National Open Record is set on this course, or at the discretion of USA Track & Field, a validation remeasurement may be required to be performed by a member of the Road Running Technical Council. If such a remeasurement shows the course to be short, then all pending records will be rejected and the course certification will be cancelled.

***This certification expires on December 31 in the year***

**AS NATIONALLY CERTIFIED BY:**

Date: \_\_\_\_\_

# Matthew Bean Memorial 5K

## Pembroke MA

Measured 8/31/08  
By Steve Vaitones



**USA**  
TRACK & FIELD™

USATF Certification #MA08015JK  
Expires Dec 31, 2018  
(Drop 0 m/km, Separation 0%)



START - FINISH

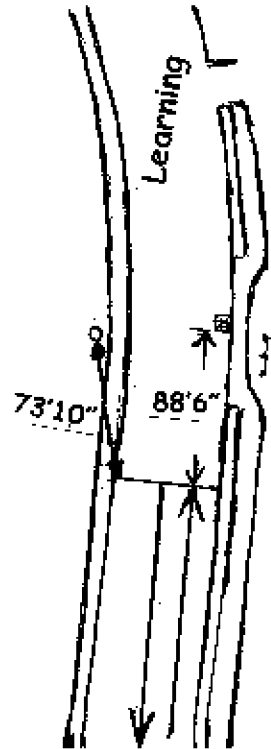
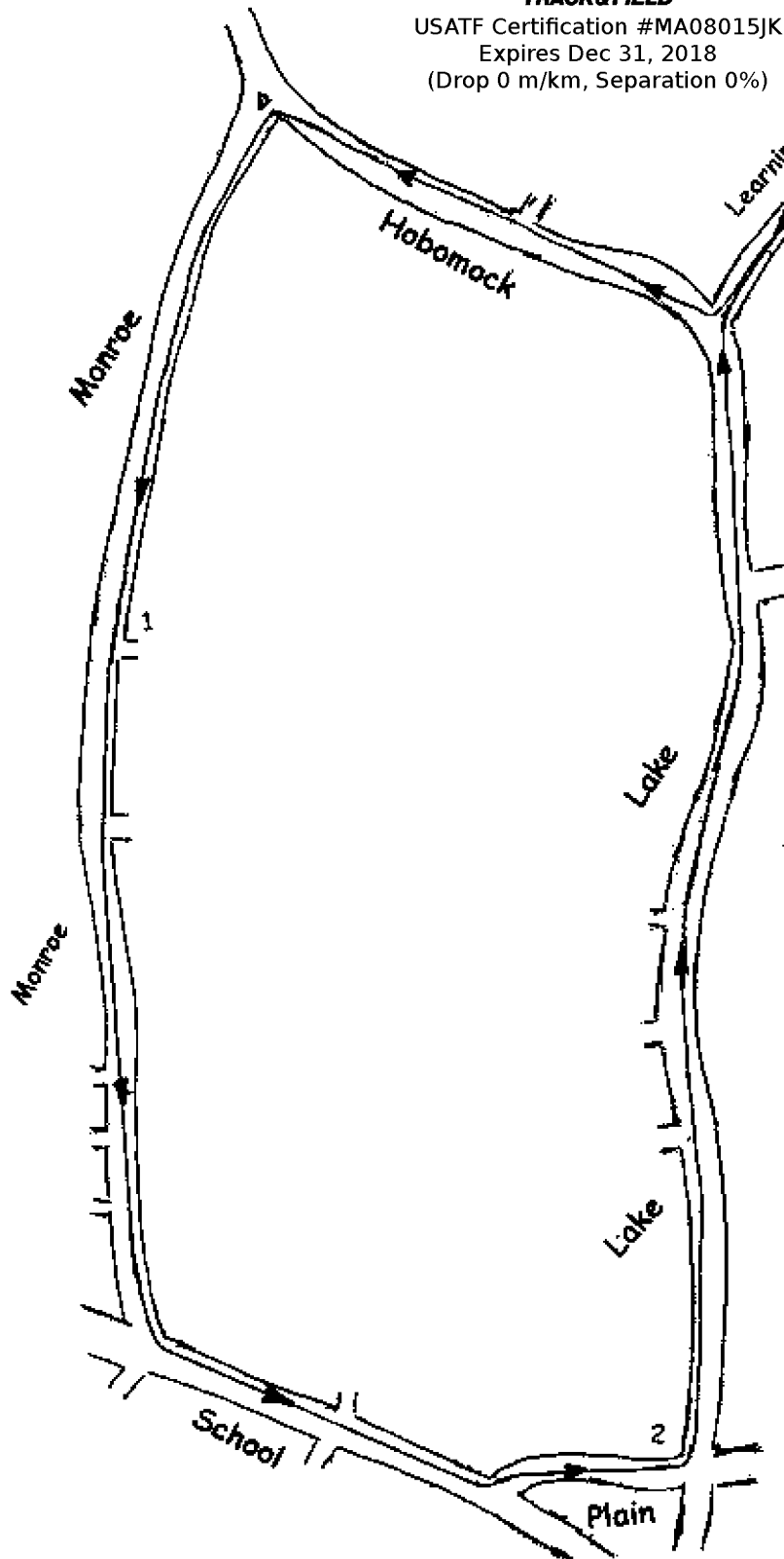

**Start:** Learning Lane (driveway to schools)  
South of first driveway to fields on east side  
88'6" south of storm near short fence  
and 73'10" south of base of pole 6 measured to curb  
South on Learning Ln, Right (north) on Hobomock  
Left on Monroe  
1 Mile - 31' before curb at Kerri Ln,  
Left on School (Rt 27), bear Left on Plain  
2 Mile - 41' before pole 69 at corner of Plain - Lake  
before turn (and before 153 Lake side driveway)  
Left on Lake, Continue on Lake, becomes Hobomock  
Right on Learning  
3 Mile 3' before end of 2<sup>nd</sup> short fence on right  
(5' past concrete culvert behind fence)  
**Finish:** Same as Start

Note: Course can be run in reverse direction.  
1 mile is 6' into driveway of 137 Lake. 3 mile is same.